

## OTTONE

Surface Mounted/Suspended Downlight



|  |                  |  |                 |  |                       |  |                        |  |  |  |  |
|--|------------------|--|-----------------|--|-----------------------|--|------------------------|--|--|--|--|
|  | Class II<br>220V |  | IP Rating<br>20 |  | Material<br>Aluminium |  | Install Person/s<br>1x |  |  |  |  |
|--|------------------|--|-----------------|--|-----------------------|--|------------------------|--|--|--|--|

**CAUTION** – This product must be installed by a qualified installer  
Please read instruction manual carefully before installing luminaire

**Surge Protection**  
For comprehensive protection of a luminaire against electrical surges, surge protection shall be installed on the mains supply where required to protect luminaires and drivers from transient voltage damage.

### Warranty

Please read these installation instructions carefully before installing this product. This product must be installed and maintained by a suitably qualified person/s in compliance with the latest applicable regulations and relevant legislation. UOZU does not warrant any claim based on defects or damage caused by misuse, improper installation, improper operation and/or modifications carried out by the purchaser or third parties. This product shall not be used as a 'working light' during construction. This will result in the warranty of the product to be void. For warranty duration, please refer to the data sheet.

### Product type



### Attention



1. Please put on gloves when installing, keep the lamp body clean, so as not to stain.
2. This luminaire is for indoor use only.
3. Non professional operators are strictly forbidden to disassemble lamps, so as not to damage the lamps.
4. Beware of electric shock and burns. Please cut-off the power supply and cooling lamps before installation and maintenance.
5. The surface of the lamp is forbidden to be contacted or wiped by any chemical solution.
6. Lamps and lanterns cannot be covered by heat insulation pads or similar materials.
7. The LED chip is sensitive to switching transients. Lamps and appliances must be connected in a power off status without hot plug.
8. If the installation is not correct, the lamp may fall or not light. Please refer to the installation instructions for re-installing.

## Surface-mounted

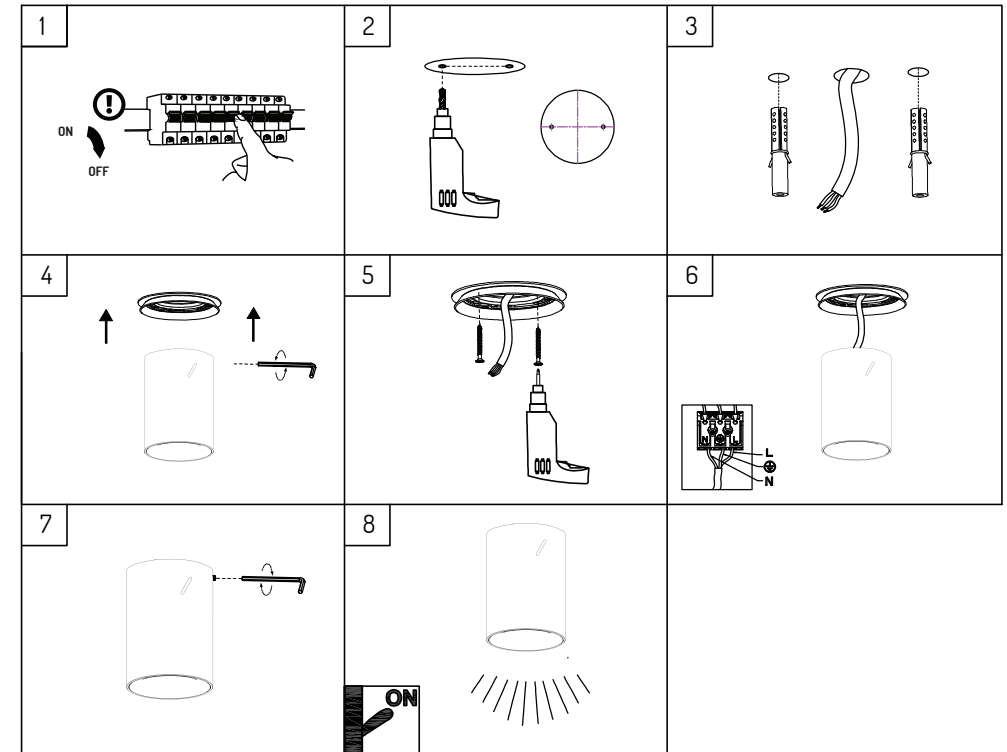

### Dimming

For dimming capabilities, luminaire must be paired with dimmable driver. Please refer to driver's instructions for pairing of suitable systems.

### Disposal

Ensure correct disposal of this product (waste electrical and electronic equipment).



### Ambient Conditions

Recommended to install in an ambient temperature <35°C.

