

Adjustability

Hole size  Ø67*H65mm

Product Specifications

Input Voltage	AC 220 -240V, 50-60Hz
Fixture Power	3W
Driving Current	700 mA
Lumen Output*	15 lm
Fixture Efficiency	5 lm/w
CRI	90
Color Temperature	2700K/3000K/4000K
Beam Angle	Asymmetric
Source Type	Citizen COB LED
Power Factor	-
Shielding Angle	60°
Control Method	Not dimmable

MacAdam Ellipse	<3 SDCM
CCT Tolerance	± 100 K
UGR	/
Product Dimensions	75*75*39.5 mm
Hole Size	Ø67*H65mm
Weight	/
Package Size	/
Carton Size	/

Safety Class	Class II
Ambient Temperature	-20°C-50°C
Storage Temperature	-20°C-50°C
Lumen Maintenance	-20°C-50°C, LED 50000H L90/B10-Ta25°
IP Rating	IP20
Housing Material	Machined Aluminium
Housing Color**	RAL 9006, RAL 9016, RAL 9005
Warranty	3 years

*Lumen output measured @ 2700K, ambient temperature 25°C

**RAL 9006 White aluminium, RAL 9016 Traffic white, RAL 9005 Jet black

Ordering code

NO.	Housing color	Watt	CRI	CCT	Beam Angle	Control Method	Reflector
05.0101	YW - Matt white YB - Matt black XX - Customized Color	003 - 3W	90	27 - 2700K 30 - 3000K 40 - 4000K	00 - Asymmetric	F - Standard on-off P - Phase dimming A - 0/1-10V dimming D - Dali dimming	0 - No Reflector

Example: 05.0101YW003902700F0

Photometric Distribution

3W Asymmetric 2700K

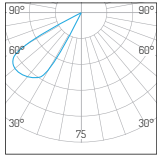

Assembly Indication

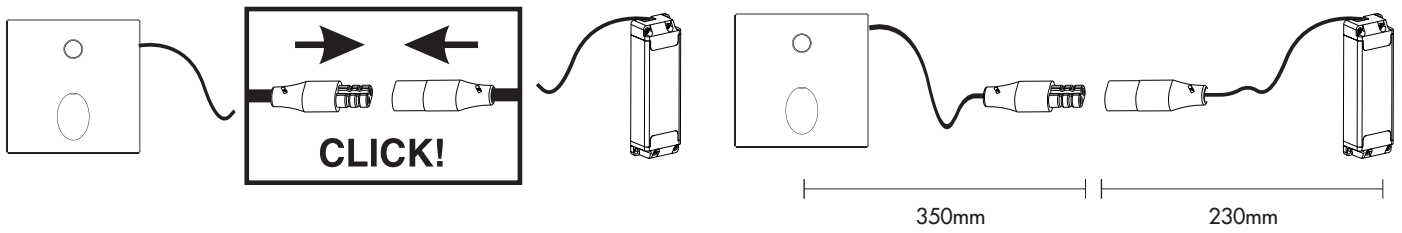

Accessories

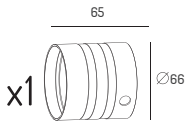

Recessed mounting box